



SYSTEM REQUIREMENTS

HARDWARE:

Apple iPad Pro
Apple Pencil or iPad
compatible stylus

SOFTWARE:

iPadOS 13.5 or Higher
Safari 13.5 or higher
Affinity 1.8.3 or higher

iPad STORAGE:

Up to 1GB of
available storage
per brush set



HOW TO DOWNLOAD AND INSTALL AFFINITY BRUSHES DIRECTLY TO YOUR iPad



AFFINITY **Serif** PANTONE® Colors. Individual brands may not match PANTONE, identified standards. Consult current PANTONE Colour Publications for accurate colour. PANTONE® and other service trademarks are the property of Pantone LLC. © Pantone LLC, 2014. Aspects of this product/Letter Technology identified in US Patent #6,712,293.

STEP 1

Ensure that iPadOS is up-to-date (13.5 or higher).

Instructions are for Safari only.

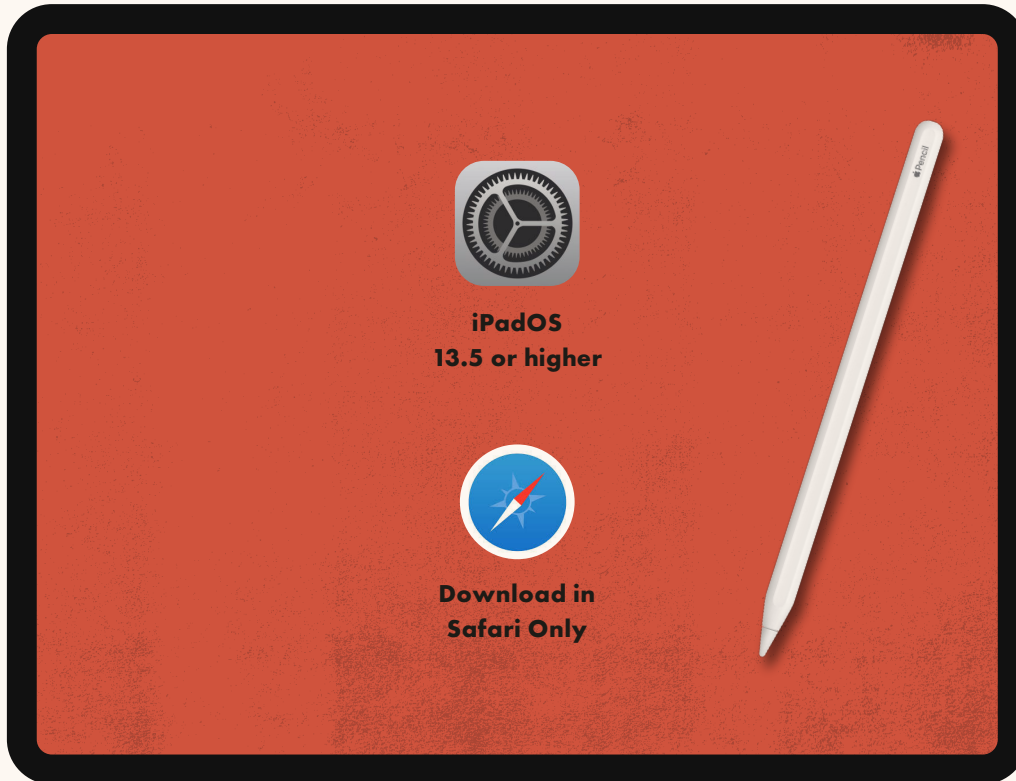

STEP 2

Open the Download Your Files page (you'll find a link in your order email) then tap the Download button to begin.

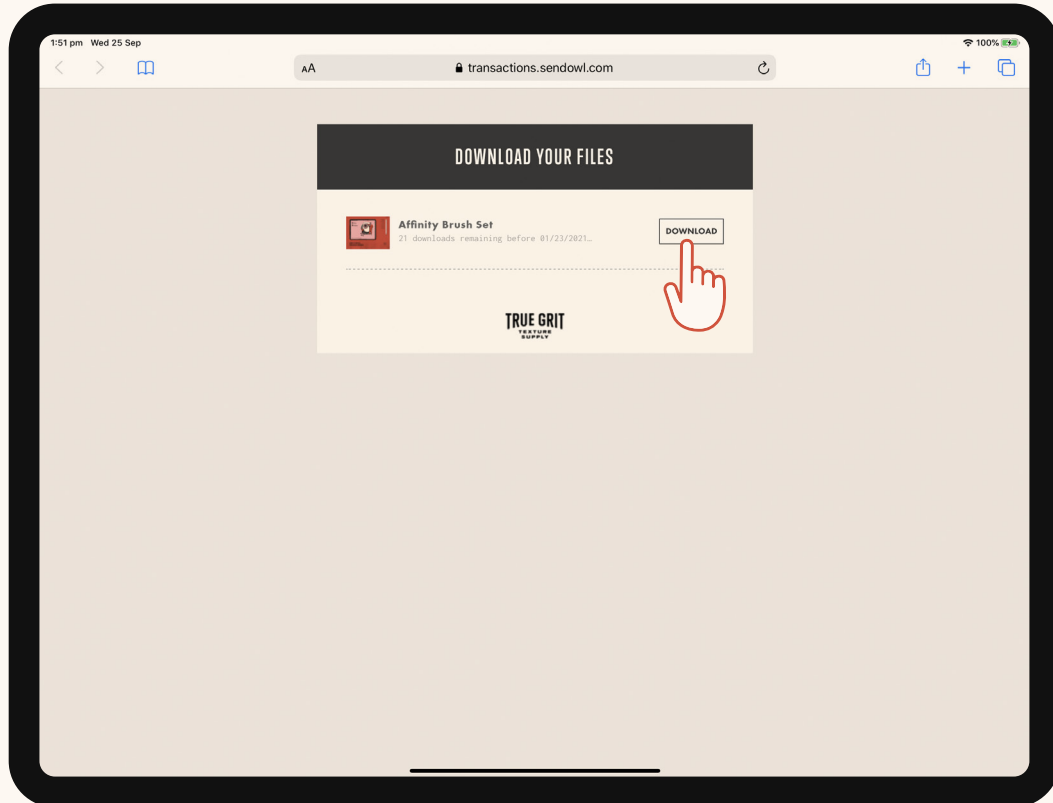

STEP 3

Tap Download when prompted.

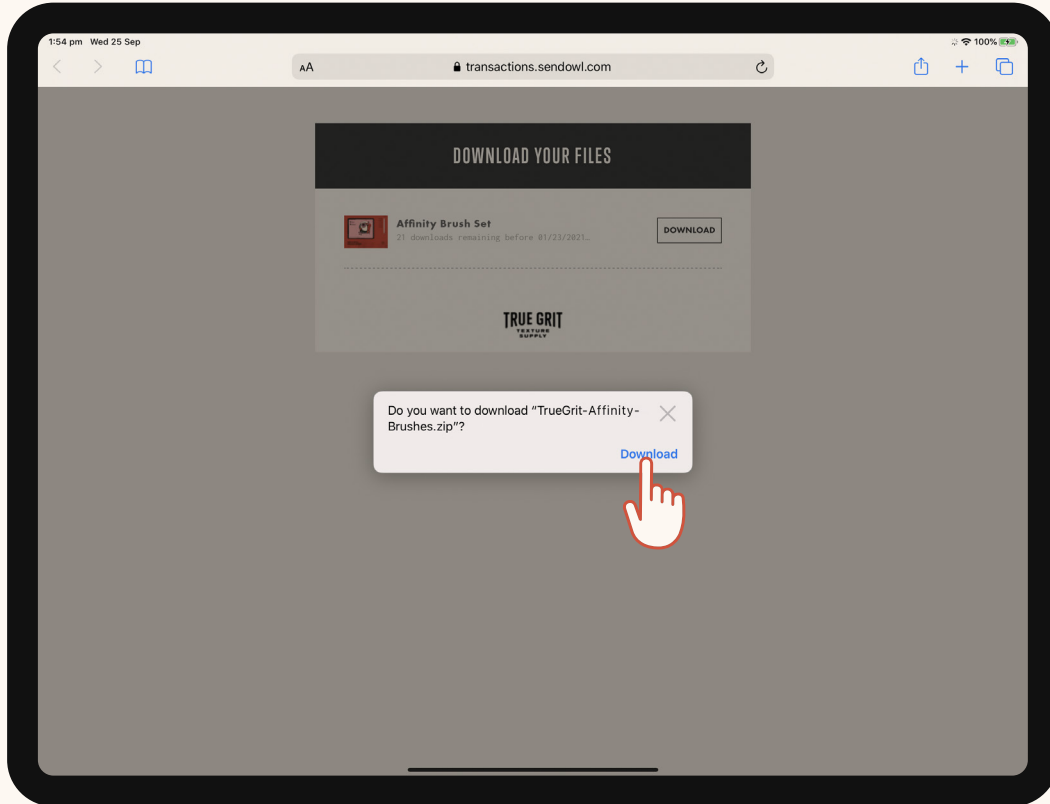

STEP 4

Tap the **Downloads Button** (a) then tap the **Magnify/Search Icon** (b).

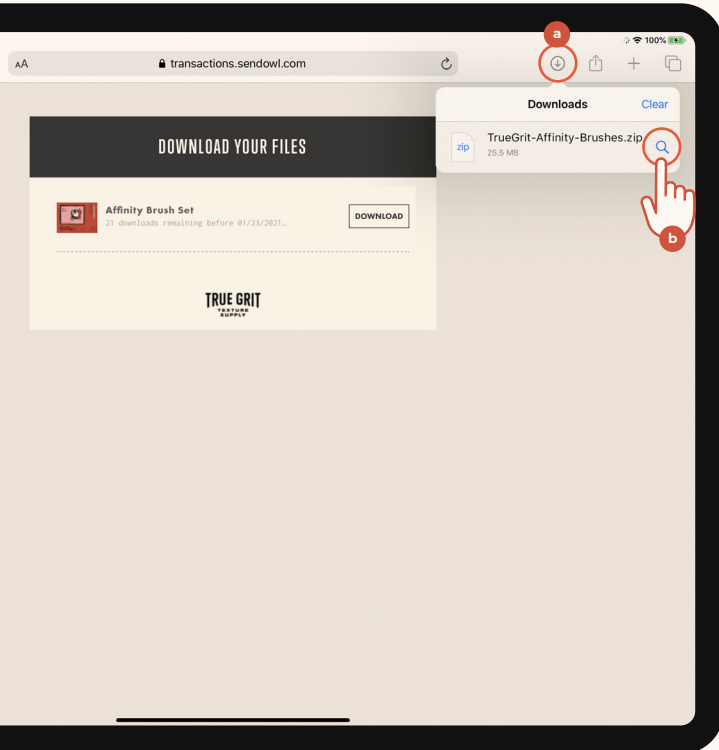

STEP 5

This opens the Downloads folder.
Wait for the zip file to download!

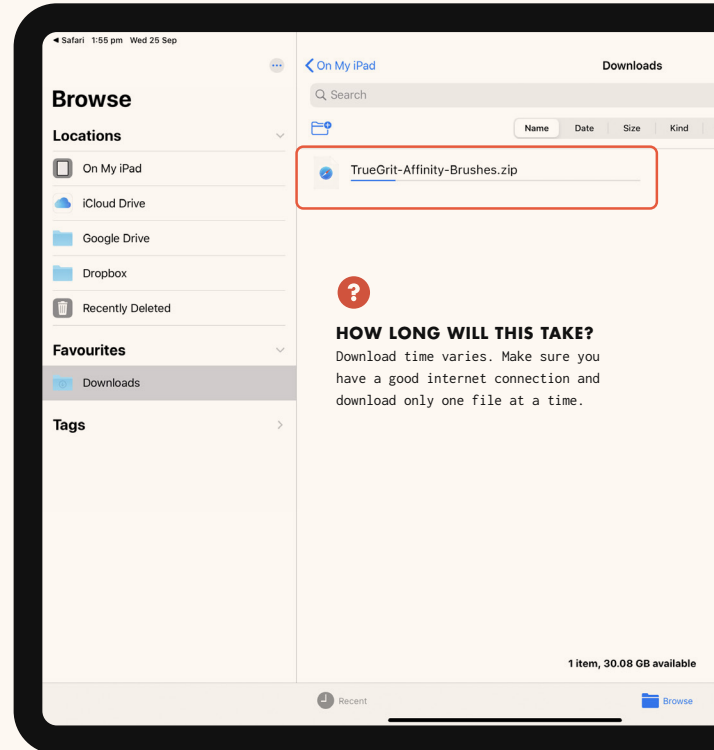

STEP 6

Tap the .zip file to extract the folder and its contents.

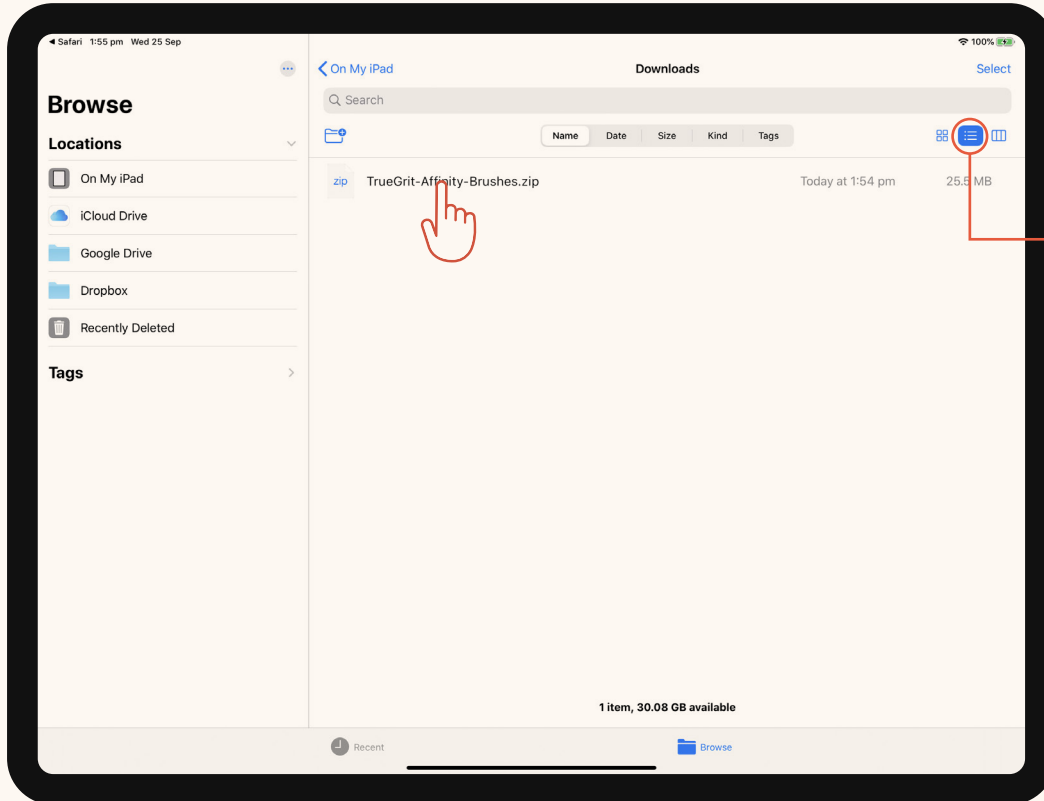

HANDY TIP

We're viewing our files in List View. Drag down to reveal the file viewing options bar.

STEP 7

To save storage space, swipe left to delete the zip file.

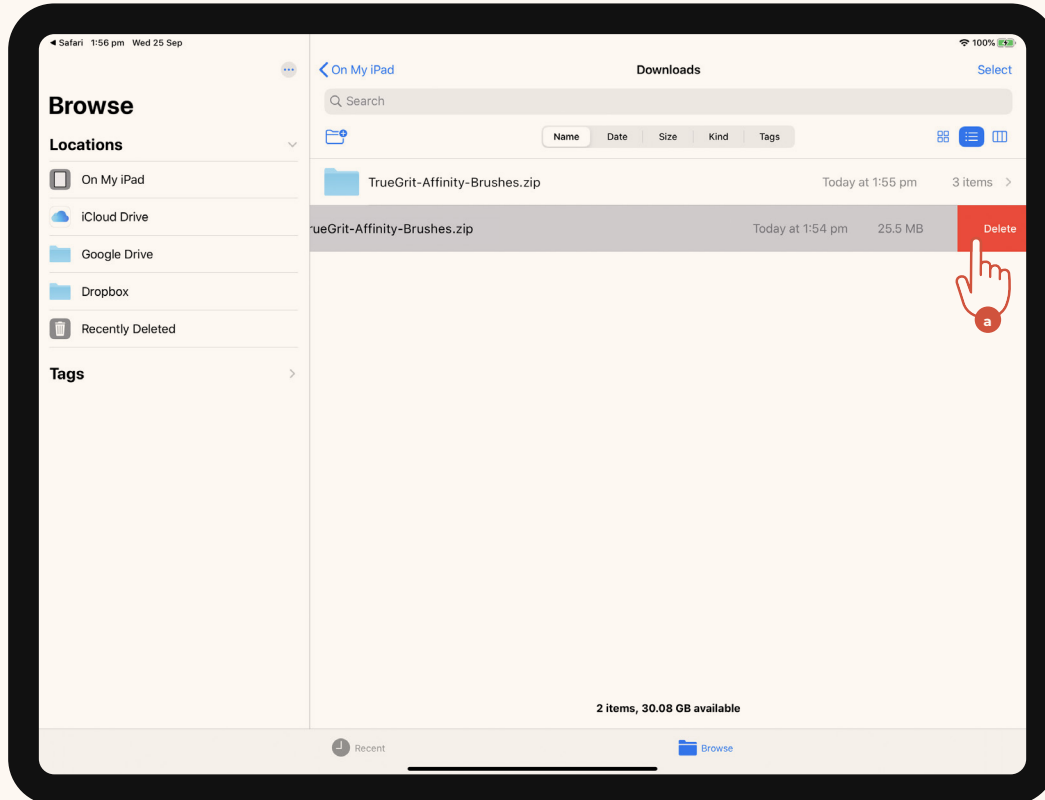

STEP 8

Open Photo or Designer then select the Paint Brush panel (a),
tap the Options menu (b) then tap Import Brushes (c)

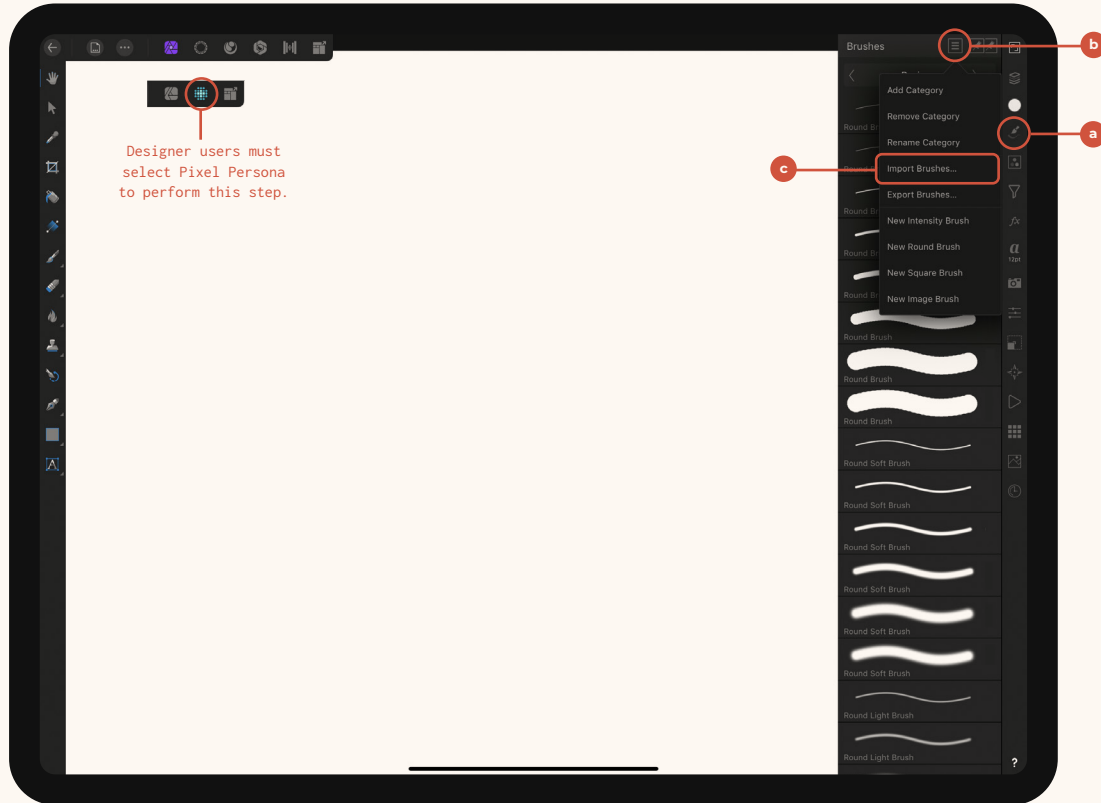

STEP 9

The file browser will open. Go to Downloads (a) then open the downloaded product file followed by the Install These Files folder (b). Tap the first brush set to install it (c). You can only install 1 brush set at a time.

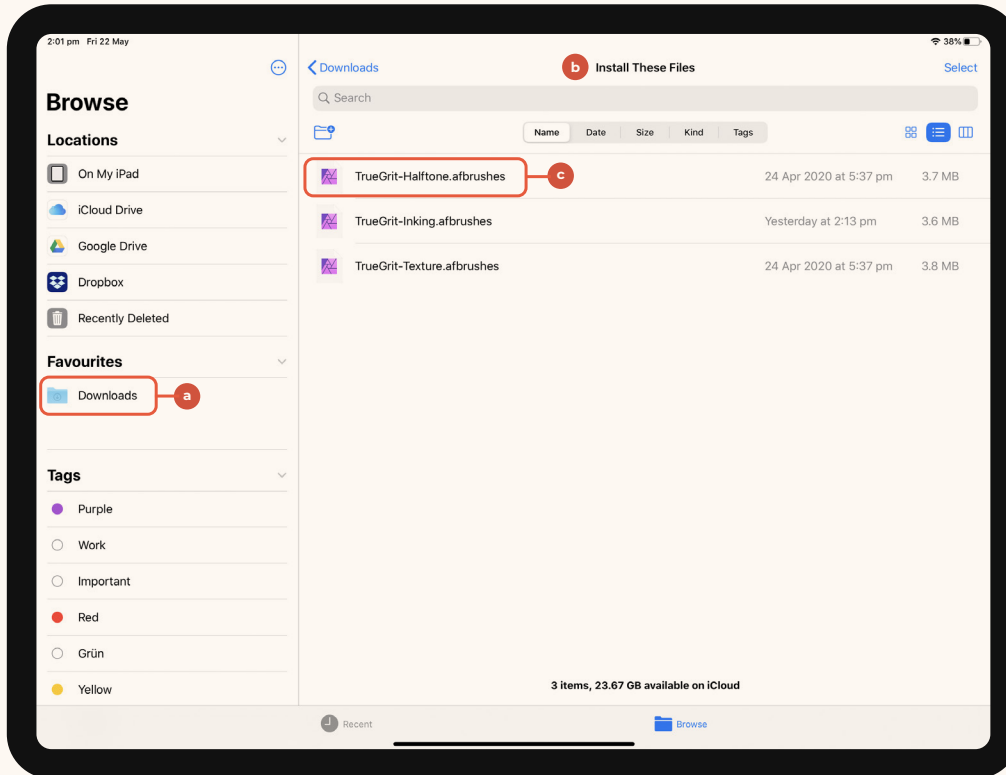

STEP 10

Repeat steps 8 and 9 for all remaining brush sets.

ALMOST THERE

Your brushes are installed and are almost ready to use. But first, we need to edit the pencil pressure curve so your brushes behave as intended.

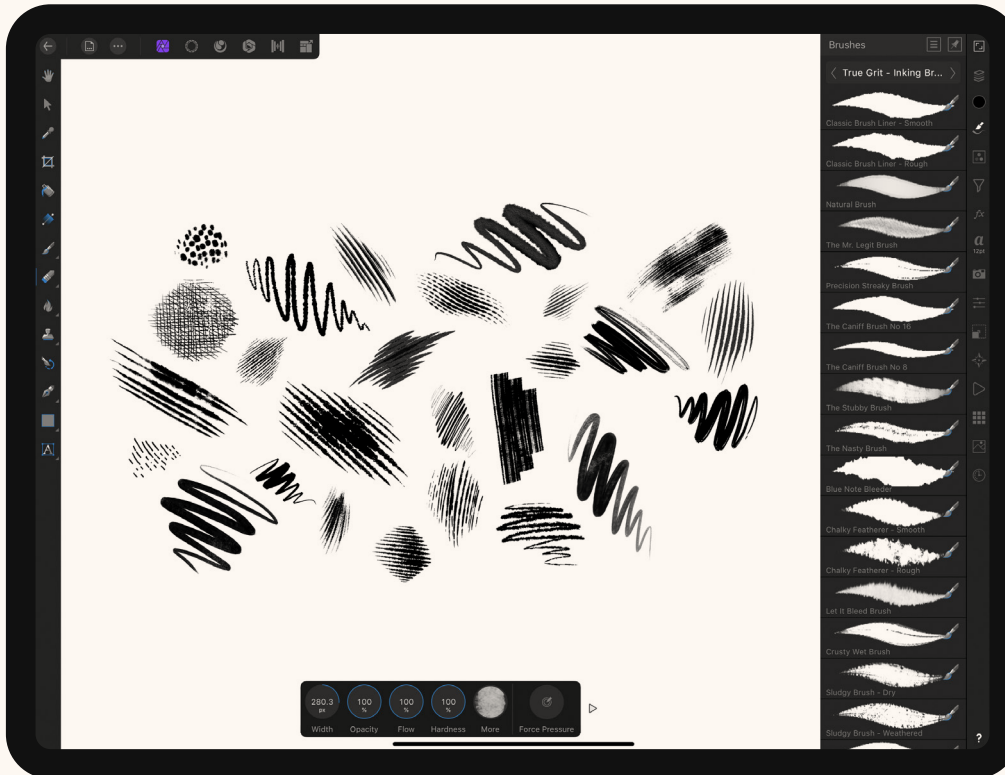

ABOUT iPad PRESSURE CURVE SETTINGS

Affinity's brush engine behaves a little differently on the iPad causing some brushes to lose their nuance and sensitivity. This is especially problematic when using inking or shading brushes.



Affinity Desktop



Affinity iPad



SOLUTION

Learn how to customise your pencil pressure curve below.

HOW TO CUSTOMIZE YOUR PENCIL PRESSURE CURVE SETTINGS

STEP 1

Tap the back/arrow button to go to the welcome screen.

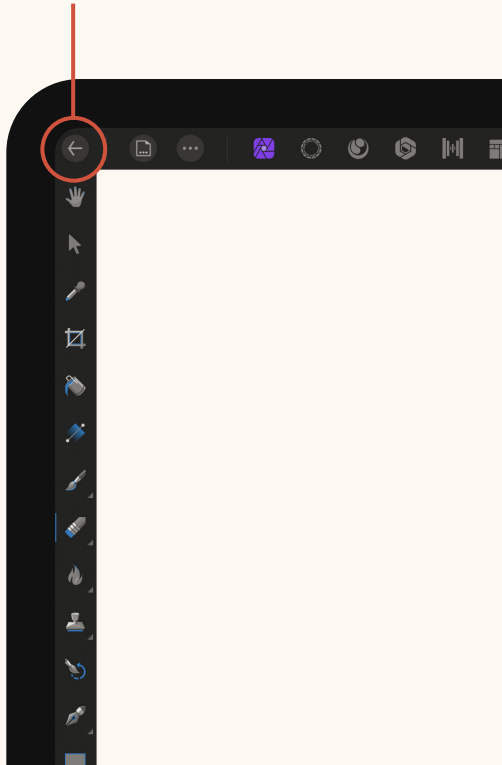

STEP 2

Tap the cog icon to go to the settings screen.

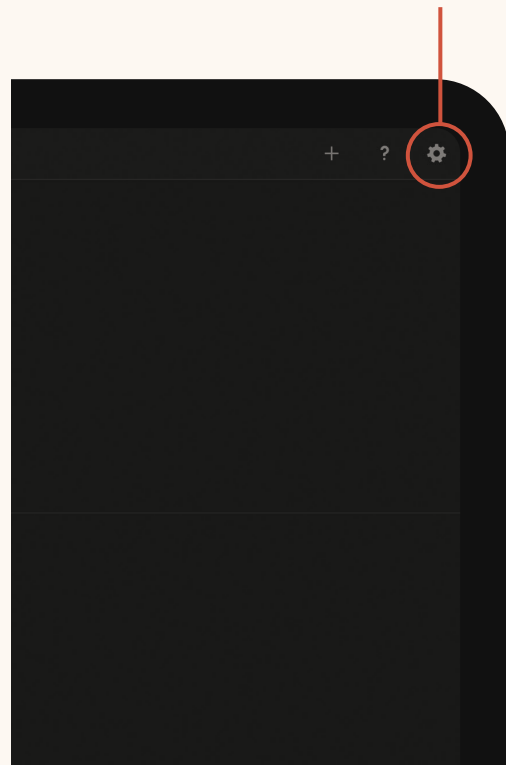

STEP 3

Tap the Pencil tab (a), choose Paint Brush Tool from the Tool menu (b) then adjust the pressure curve as shown (c). Tap Done to save the new settings.

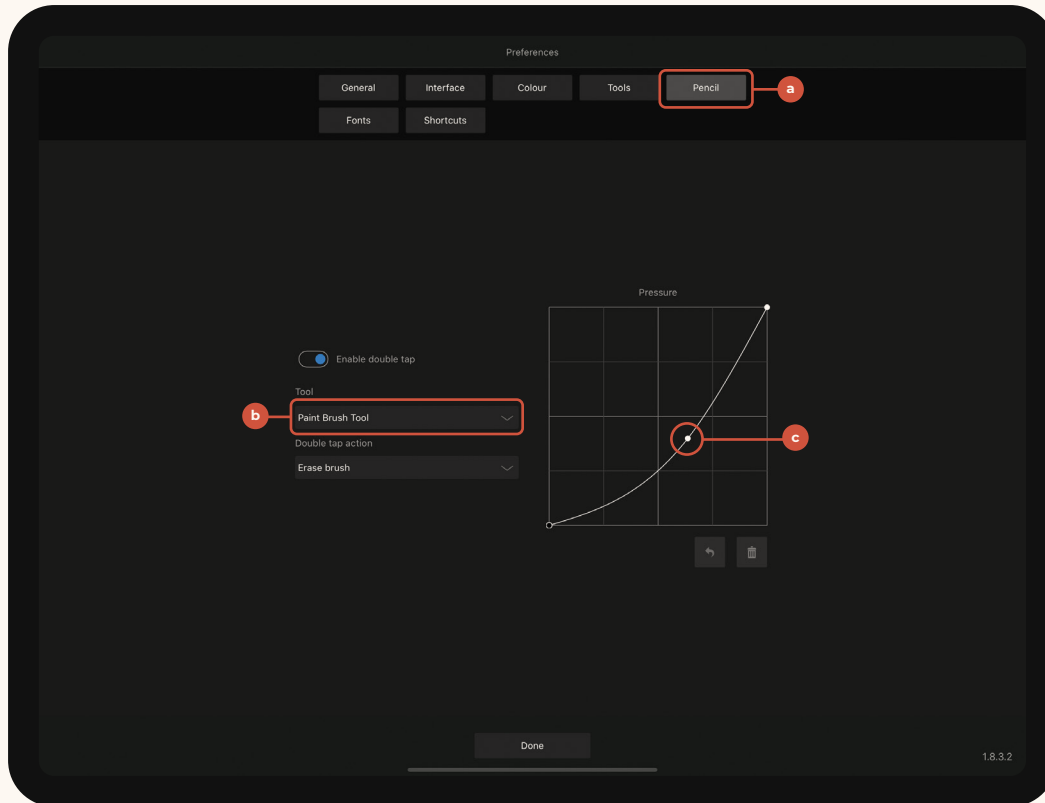

SUCCESS! YOU'RE NOW READY TO USE YOUR NEW AFFINITY BRUSHES.

TRUE GRIT
TEXTURE
SUPPLY

DOES YOUR PACK INCLUDE OTHER INSTALLABLES?

- [How to install Affinity macros](#)
- [How to install Affinity graphic styles](#)



Share Your Work

We regularly share our favorite customer work on our gallery page and Instagram so if you make something rad don't forget to tag us.



@truegrittexturesupply

True Grit Help & Support

We're always here to help with issues related to any True Grit Texture Supply product if you get stuck or things get weird.

[VISIT TRUE GRIT SUPPORT](#)

Affinity Help & Support

Visit Affinity support for in-depth tutorials, to report a bug, search help forums or get one-on-one help with any Affinity specific issue.

[VISIT AFFINITY SUPPORT](#)